

CRITERIA 7

7.1.3 - Describe the facilities in the Institution for the management of the following types of degradable and non-degradable waste (within 200 words) Solid waste management, Liquid waste management, Biomedical waste management, E-waste management, Waste recycling system, Hazardous chemicals and radioactive waste management

SOLID WASTE MANAGEMENT



LIQUID WASTE MANAGEMENT



PADMABHOOSHAN VASANTRAODADA PATIL INSTITUTE OF TECHNOLOGY,
BUDHGAON.

NOTE ON DRAINAGE SYSTEM IN THE CAMPUS

The sewage disposal in the campus is done by septic tank system. Adjacent to every toilet block septic tank of adequate capacity is provided. The effluent of the septic tank is fed to the soak pit. The grey water (Bath Room Waste water) is collected in a separate tank which is supplied to the trees and plants in the campus through a pipe line network.

Campus Maintenance I/c

Principal
Principal
Padmabhooshan Vasantodade Patil
Institute of Technology
BUDHGAON - 416 304

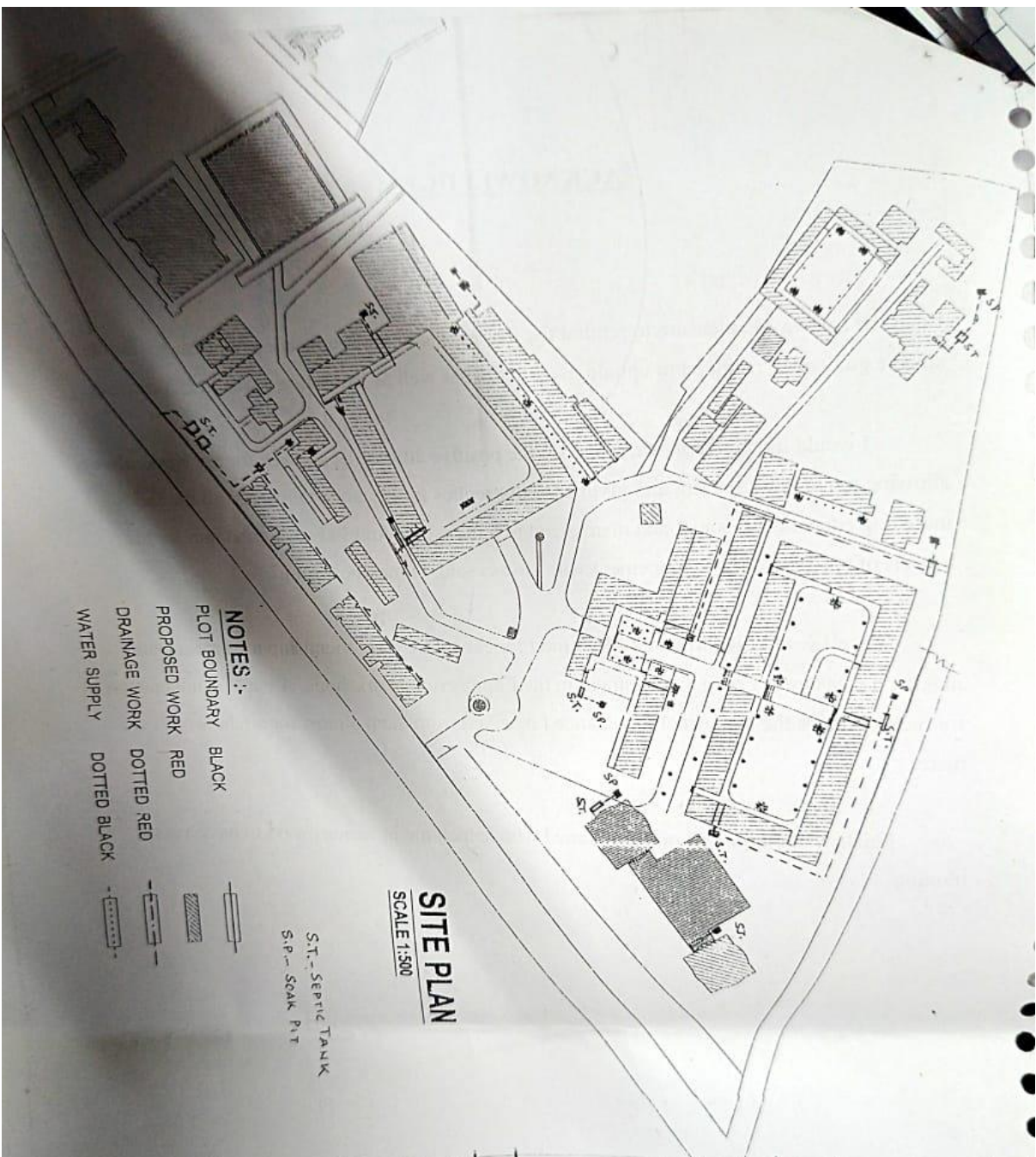

- NOTES :-**
- PLOT BOUNDARY BLACK
 - PROPOSED WORK RED
 - DRAINAGE WORK DOTTED RED
 - WATER SUPPLY DOTTED BLACK

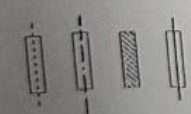

S.T. - SEPTIC TANK
S.P. - SOAK PIT

SITE PLAN
SCALE 1:500

PROPOSED CONSTRUCTION OF
ADMINISTRATION AND ENG. DEPTS
FOR PADMABHOSHAN
VASANTRAODADA PATIL INSTITUTE OF
TECHNOLOGY, BUDHGAON

APPROVAL DRAWING



CHAUGULE PATIL
CONSULTANTS PVT. LTD.
Architects, Engineers, Planners,
Valuers
SANGLI - 416 416 (Maharashtra)
TEL: (0203) 287800
FAX: (0203) 287800

Prepared by	Checked by	Scale
M.K.	S.A.P.	1:41
Date	14/07/20	2

BIOMEDICAL WASTE MANAGEMENT

